

---

Date:	8-Mar-16	Distribution:
Project:	UT Health MSB Infill Renovation	Judson Lloyd (UT Health) Laura Lander (UT Health)
Project No.:	214-198	Dustin Nicholson (PWP)
Addendum No.:	Three (3)	John Kaufman (PWP)

---

**Notice to All Bidders**

This Addendum forms a part of the Contract Documents and modifies the original Specifications and Drawings, issued 15 January 2016, to the extent noted hereinafter.

All parties of interest shall take careful note of this Addendum so that proper allowance is made in all computations, estimates and contracts and so that all trades affected are fully advised in the performance of work that will be required by them.

This Addendum supersedes all previous Drawings, Specifications, and instructions pertaining to these items.

---

**A. Drawings**

- Item 1.01           The following listed drawings, dated 8 March 2016 are being issued as Addendum No. Three (3) as REVISED:
- A-110           Floor Plan - Offices and Grab N Go
  - A-110.1       Floor Plan - Temporary Grab N Go
  - A-111           Floor Plan – Level 1
  - A-131           Equipment and Furniture Plan
  - A-161           Reflected Ceiling Plans
  - A-540           Door and Window Details, Room Finish and Material Schedule

**B. Specifications**

- Item 1.02           The following listed Specifications, dated 8 March 2016 are being issued as Addendum No. Three (3) as NEW:

**End of Addendum No. Three (3)**

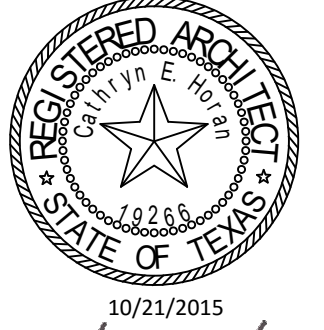

Catherine E. Homan

Structural Engineer  
**Walter P. Moore**  
1301 McKinney, Suite 1100  
Houston, TX 77010  
(P) 713-630-7300

MEP Engineer  
**E&C Engineers and Consultants**  
1010 Lamar St  
Houston, TX 77002  
(P) 713-580-8800

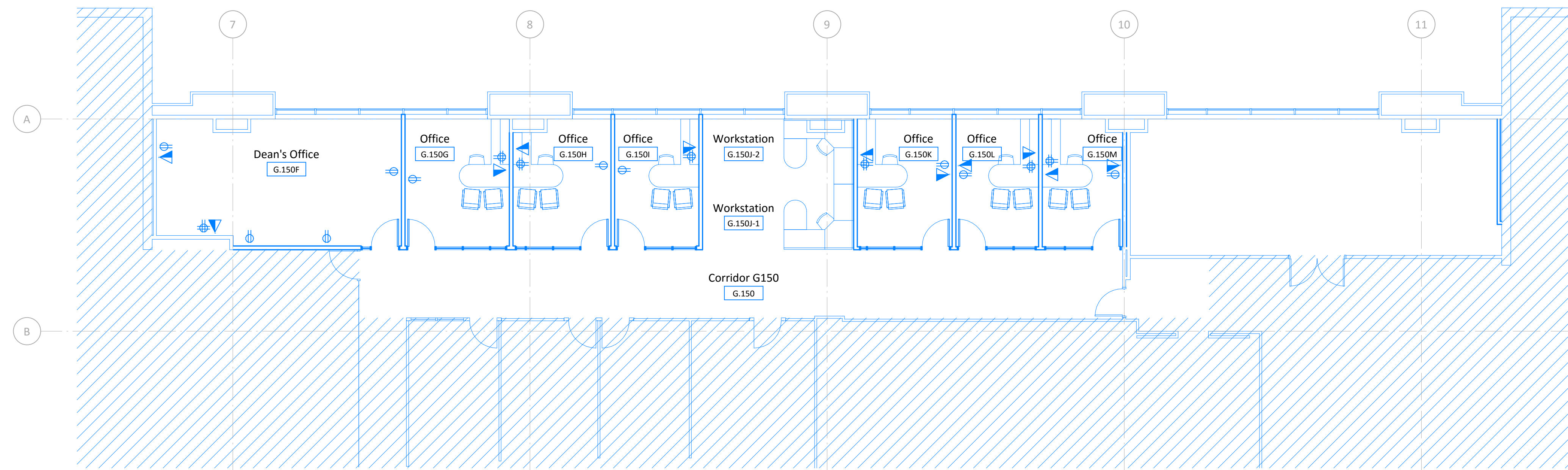

- General Notes - Office Equipment Plan**
1. Refer to MEP drawings for power, voice and data for Workstations G.150J-1 and G.150J-2

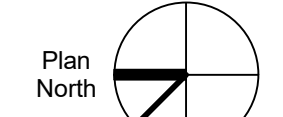

Ground Floor - Office Equipment Plan 1/8" = 1'-0" 4

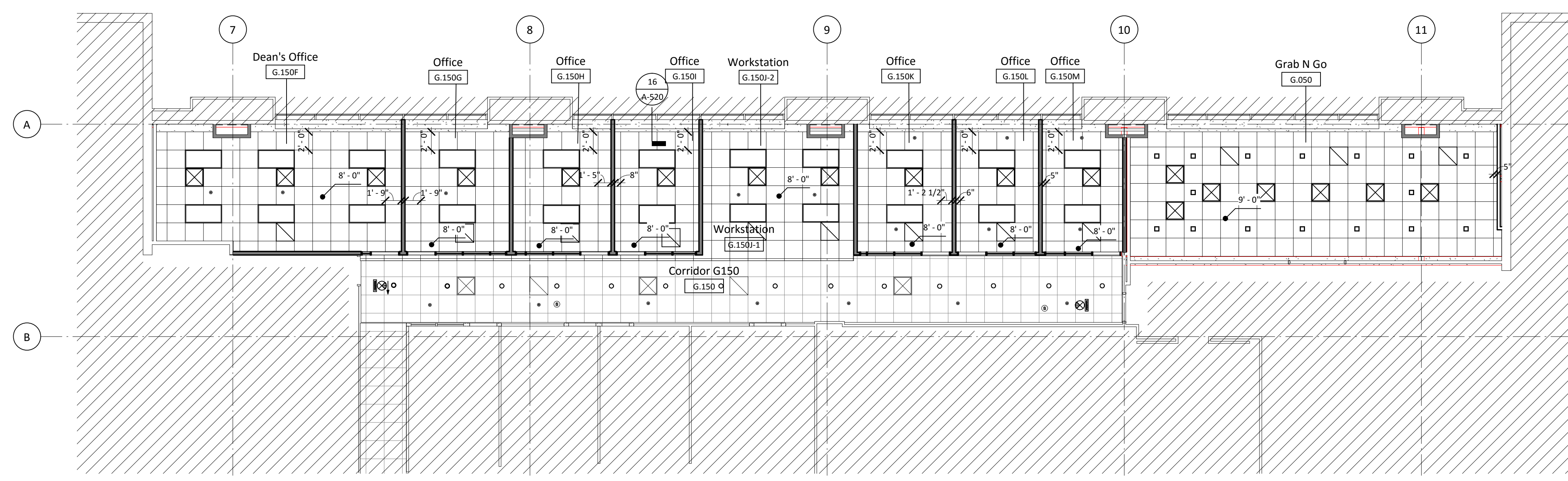

- General Notes - Reflected Ceiling Plan**
1. All new ceilings to be 2' x 2' lay-in acoustical ceiling tile at 8'-0" a.f.f., unless noted otherwise. See Finish Schedule for types.
  2. See Interior Elevations for furr down heights and dimensions.
  3. Center all down lights, sprinkler heads, and wall washers in center of ceiling tile, unless noted otherwise.

- Legend - Reflected Ceiling Plan**
- New partition to structure. See 1 A-520 for partition schedule.
  - Area not in scope



Ground Floor - Office Reflected Ceiling Plan 1/8" = 1'-0" 2

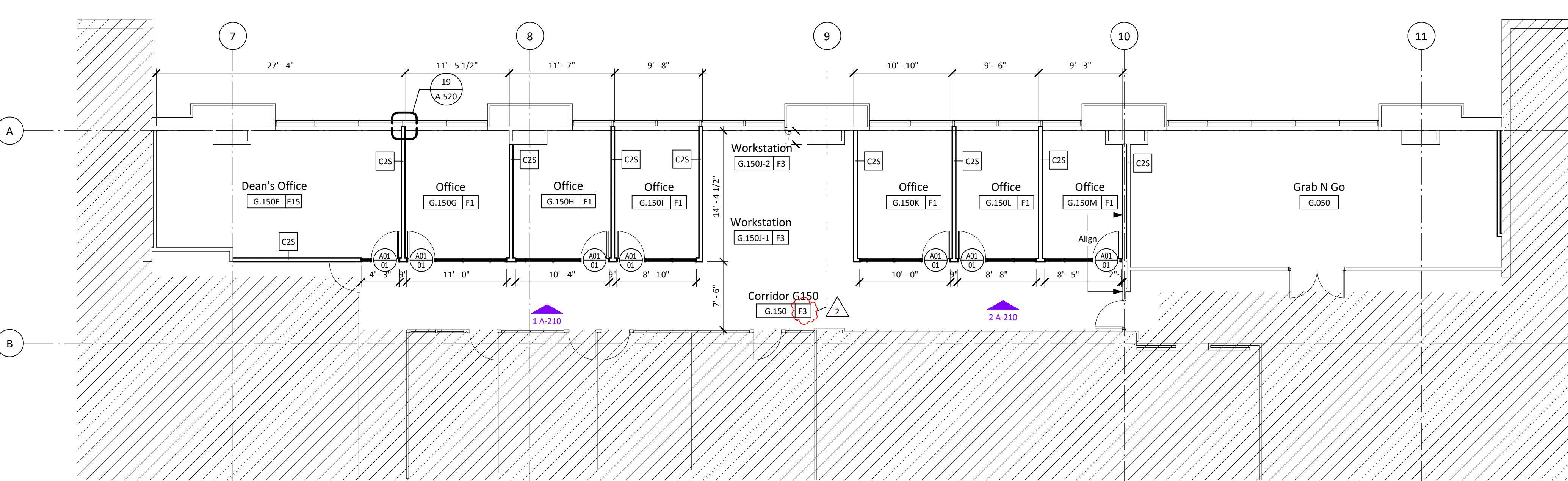

- General Notes - Floor Plan**
1. All dimensions are to face of gypsum board unless noted otherwise.
  2. See A-520 for Partition Type Schedule.
  3. See A-540 for Door Schedule.
  4. All partitions to be C25 unless noted otherwise.

- Legend - Floor/Demo Plan**
- Existing to be removed
  - Existing to remain
  - New Partitions
  - Area not in scope



Ground Floor - Office Floor Plan 1/8" = 1'-0" 1

Issues / Revisions

No.	Date	Description
1	01/22/2016	Issued For Construction
2	03/08/2016	Issued for Addendum #3

## MSB 1st Floor Infill



### Floor Plan - Offices and Grab N Go

Copyright (C) 2015 by PhiloWilke Partnership. All rights reserved.  
This document and the information herein is the property of PhiloWilke Partnership. No part hereof shall be copied, published, distributed, disclosed or used in any manner whatsoever except as expressly authorized by PhiloWilke Partnership. Any person, firm, or corporation receiving this document, however obtained, shall be deemed to have agreed to the foregoing conditions and that this document will be held in trust and confidence subject only to the private use expressly authorized by PhiloWilke Partnership.





*Catherine E. Horn*

Contractors:

Structural Engineer

**Walter P. Moore**  
1301 McKinney, Suite 1100  
Houston, TX 77010  
(P) 713-630-7300

MEP Engineer

**E&C Engineers and Consultants**  
1010 Lamar St  
Houston, TX 77002  
(P) 713-580-8800



Legend - Reflected Ceiling Plan

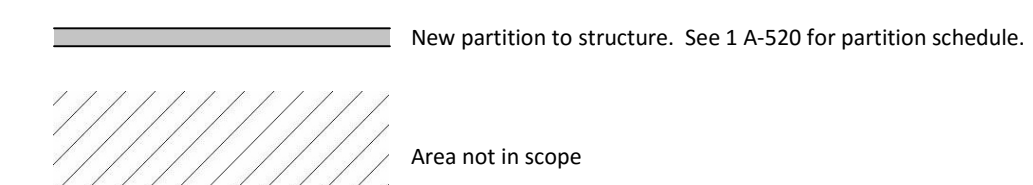

Ground Floor - Temporary Grab N Go Reflected Ceiling Plan

1/4" = 1'-0"

2

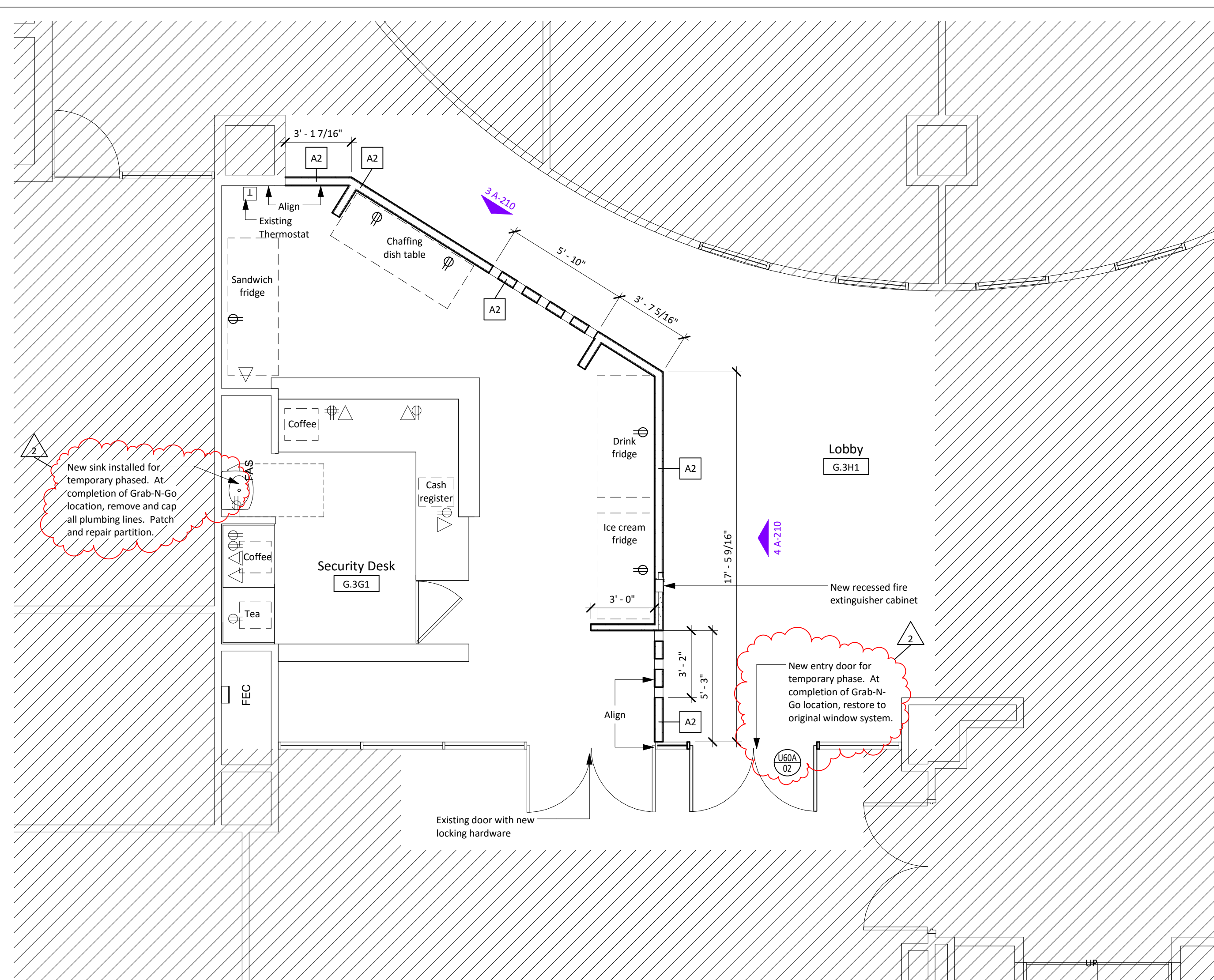

Legend - Floor/Demo Plan

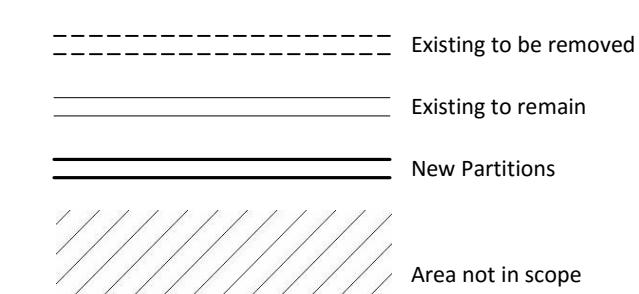

Ground Floor - Temporary Grab N Go Floor Plan

1/4" = 1'-0"

1

**General Notes - Floor Plan**

1. All dimensions are to face of gypsum board unless noted otherwise.
2. See A-520 for Partition Type Schedule.
3. See A-540 for Door Schedule.
4. All partitions to be C25 unless noted otherwise.

**MSB  
1st Floor Infill**



**Floor Plan - Temporary  
Grab N Go**

Copyright (C) 2015 by Philo Wilke Partnership. All rights reserved.  
This document and the information herein is the property of Philo Wilke Partnership. No part thereof shall be copied, published, distributed, disclosed or used in any manner without the prior written approval of Philo Wilke Partnership. Any person, firm, or corporation receiving this document, however obtained, shall be deemed to have agreed to the foregoing conditions and that this document will be held in trust and confidence subject only to the private use expressly authorized by Philo Wilke Partnership.

Print Date / Time: 3/8/2016 5:45:39 PM

Phil Wilke Commission Number  
214-198R

Sheet Number  
A-110.1











